

# MS914114

MS914144  
CST914

## Dorian™ 1.6 Gpf Toilet, Elongated, Power Gravity®, UniFit Rough-In

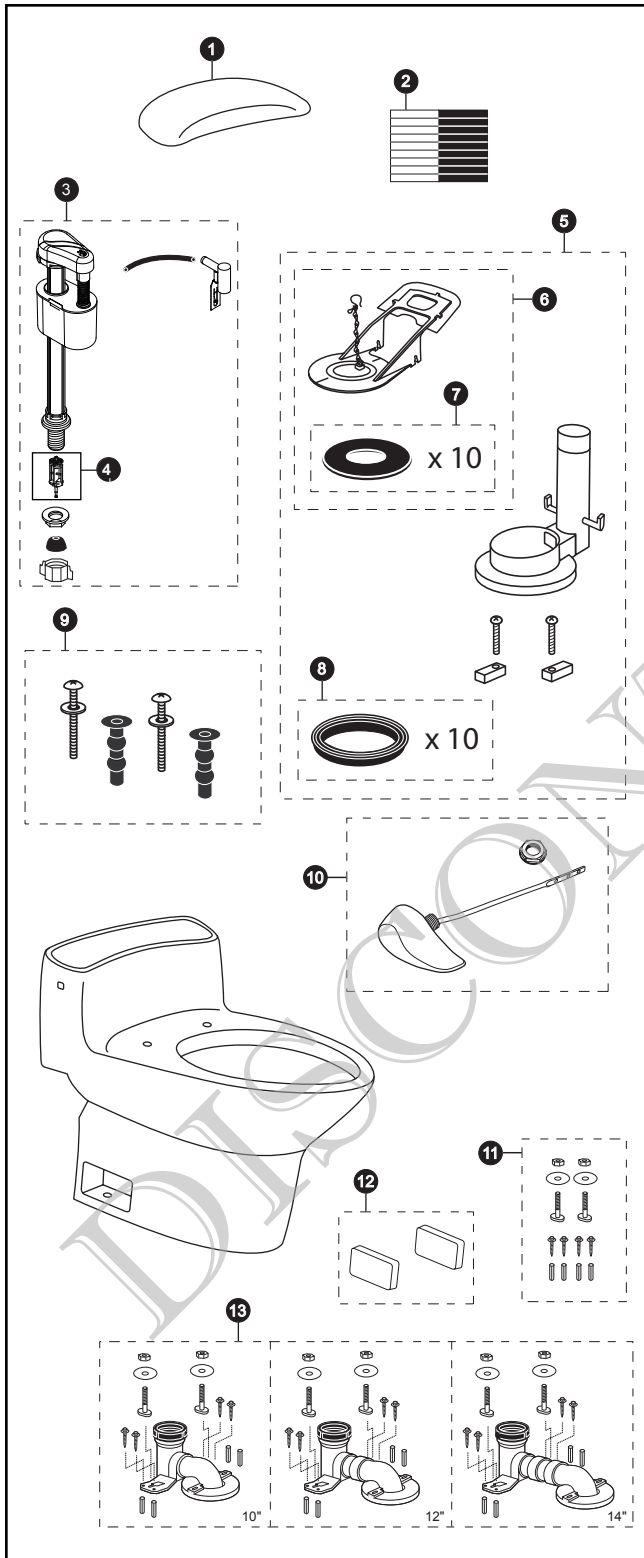

Item	Part	Description
1	TCU914CR#01 TCU914CR#03 TCU914CR#04 TCU914CR#11 TCU914CR#12 TCU914CR#51	Tank Lid w/ Velcro Tape
2	THU107	Velcro Tape
3	TSU17A	Fill Valve
4	THU229	Fill Valve Filter
5	THU128	Flush Valve
6	THU092-8	Flapper w/ Chain
7	THU096	Flapper Gaskets (for 10 toilets) (10 Pieces)
8	THU097	Flush Valve Gaskets (10 Pieces)
9	THU651N	Top Mounting Seat Hardware
10	THU099#01 THU099#03 THU099#04 THU099#11 THU099#12 THU099#51 THU099#CP THU099#PB	Trip Lever
11	THU020	UniFit Mounting Set
12	TCU914CV#01 TCU914CV#03 TCU914CV#04 TCU914CV#11 TCU914CV#12 TCU914CV#51	Side Plates w/ Velcro Tape
13	TSU01W.10 TSU01W.12R TSU01W.14	UniFit - 10" Rough-In UniFit - 12" Rough-In UniFit - 14" Rough-In

### Product Number Explanations

#### One-Piece Toilet

(MS) Toilet & Seat Combination  
(914) Toilet Model  
(114) Seat Model

#### One-Piece Toilet

(CST) Gravity Type Toilet  
(914) Model

#### Colors

(#01) Cotton  
(#03) Bone  
(#04) Gray  
(#11) Colonial White  
(#12) Sedona Beige  
(#51) Ebony

#### Finishes

(#CP) Chrome Plated  
(#PB) Polished Brass