

Sound Experience

THU9201

TOTO

1155 Southern Road
Morrow, GA 30260
(770) 282 8686

For your safety, be sure to inspect your Sound Experience occasionally.

- Is the power plug abnormally hot?
- Is the power plug covered with dust?
- Is the outlet loose?
- Is your Sound Experience operating differently than usual?

* In case anything is abnormal, contact TOTO USA to prevent a fire or an electrical shock.



Introduction	2
Important Safeguards	2
User Warnings	3
Proper use	3
Components	3
Before use	4
Before playing music	4
Play music	5
Adjust volume	6
Jump (skip function)	6
Jump to the Beginning	7
Fast forward/rewind	7
Random play - RDM Repeat play - REP	8
Music Quality Setting - Equalizer	8
Privacy Plus - Water saver	9
Favorite Songs	9
Maintenance	10
Troubleshooting	10
Specifications	11
Limited Warranty	11

■ Thank you for choosing the sound experience.
Please read the manual carefully for correct use.

■ Please keep this manual in a safe place.

Read First
Use
Maintenance
Help

Introduction

The Sound Experience can play great music for you in the bathroom.

Enjoy music!

You can enjoy great music in the bathroom. By pushing the buttons on the sound experience, you can enjoy your favorite songs.

- The sound experience comes with 18 preinstalled songs as shown on the right.

※ These are hardwired into the product and cannot be deleted or overwritten.

- You can enjoy your favorite songs by downloading them onto an SD card (not included).

For details, see page 9 "Favorite Songs".

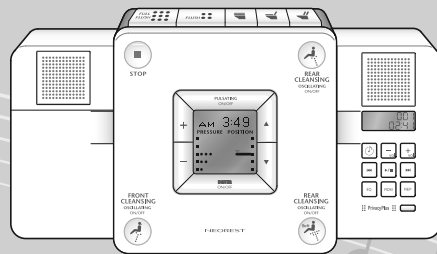

Season	Song List
Spring	1. Wild rose (TOTO original) 2. La Fille aux Cheveux de Lin 3. Wild rose of Berner 4. Waltz of flower (Jazz version)
Summer	5. Wind bell (TOTO original) 6. Je Te Veux 7. Serenade 8. Piano sonata (Jazz version)
Autumn	9. Ancient city (TOTO original) 10. Traumerei 11. Bonaparte's canon 12. Air on G string (Jazz version)
Winter	13. Silk (TOTO original) 14. Pavane pour une Infante 15. Ave Maria 16. Moonlight (Jazz version)
Healing	17. Tide (Lake with forest shadow) ※ 18. Riverlet babble (Babble and isle symphony) ※

※copyright@kenwood corporation All rights reserved

User Warnings

Follow Carefully

The following may cause poor performance

Do not cover the signal emitter on the NEOREST remote control

This may interfere with the signal to the top unit.

Do not push on the display of the Sound Experience

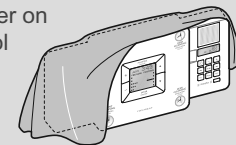

This may cause malfunction

Do not push on the display on the Sound Experience

Breakage may occur.

Proper Use

Use the Privacy Plus properly and save water.

Use the Privacy Plus

If you would like to cover up noises made while using the restroom, push . The Sound Experience will make the sound of flowing water for 25 second.

Page 9

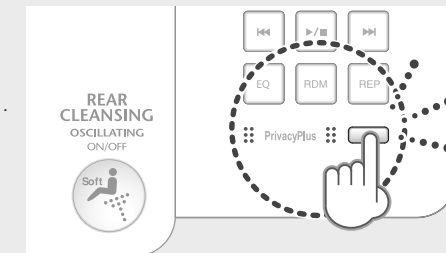

Important Safeguards Follow Carefully

For correct use of the product, please read and observe the following safeguards carefully. These warnings are important to your safety.

Meaning	Warning	Improper use or installation of this product may result in death or serious injury.
	Caution	Improper use or installation of this product may result in injury or property damage.
Example		This symbol means "Do Not". The sign on the left means "Do not tamper, repair or modify".
		This symbol is used to indicate a required step in the use of this product.

Warning

Caution

Keep dry
Keep the Sound Experience away from water or detergent.
• Failure to do this may result in fire or electric shock.

Do not install the product in a room where the humidity can exceed 90%.
 Never disassemble for repair or modification.
• This may cause fire or electric shock.

Do not! Keep the SD card out of reach of children.
• A child may swallow it by accident.
• If this happens, consult a doctor immediately.

Avoid fire
Keep fire or flame such as cigarettes and cigars away from the product.
• Failure to do this may cause fire.

Do not!
Keep magnetically-sensitive articles away from the product.
• The speaker magnet may damage credit cards, transit cards, or watches.

Do not!
Do not set the volume too high.
• Constantly listening to loud music may damage and weaken your hearing.

Components

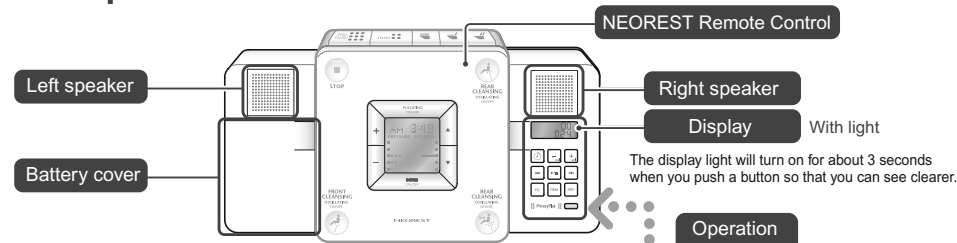

Display

1 Random/Repeat
 Page 8

Power button
 Page 4

Rewind
 Page 7

Equalizer
 Page 8

Random play ON/OFF
 Page 8

2 Equalizer Page 8
3 Song number
[Shows volume level when it is being adjusted.]
4 Playing time

Volume Page 6

Fast Forward Page 7

Start / Stop Page 5

Repeated play ON/OFF Page 8

Privacy Plus (water saver) Page 9

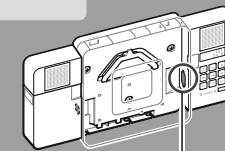

SD Card Slot (SD card not included)

Page 9

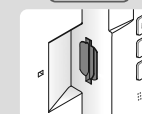

Before Use

Prepare as follows

Insert batteries in Sound Experience

When changing batteries or doing maintenance, please set ON/OFF to OFF on the top unit.

1 Remove the NEOREST remote control

Caution: When the remote control is taken off, don't place it on the NEOREST lid. Otherwise, it will scratch the lid or fall when the lid opens automatically.

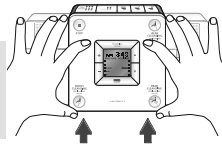

1 Push the NEOREST remote control upward from the bottom

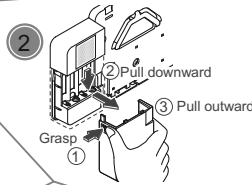

2 Hold the battery cover and pull it towards you

3 Insert 4 AA batteries

Caution:

- Use the \oplus \ominus symbols to install the batteries correctly
- When changing the batteries, use new ones and use the same brand.
- When the batteries are almost dead, the volume can only be set to a maximum of "3". Replace the batteries when this happens.

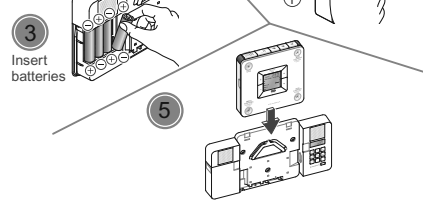

Tip: When the batteries are replaced, the equalizer settings will return to default.

4 Put the battery cover back on

5 Place NEOREST remote control back on the holder

About batteries Please use alkaline batteries. To prevent battery damage or leakage, please:

- Only use the same brand of batteries.
- Do not use rechargeable batteries.
- If the product will not be used for long period, please remove the batteries.

Before Playing music

Prepare as follows

Sound Experience Ready Mode

Before other functions can be used, the display light must be turned on. The light indicates that the Sound Experience is in Ready Mode.

* You cannot skip tracks when the display light is turned off.

1 Push ⏻

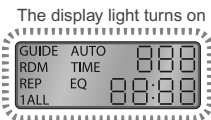

Tip: If no buttons are pushed in 2 minutes while the sound remote is in ready mode, the display light turns off.

After 3-10 seconds

2 The Sound Experience enters ready mode (display light on)

It is now possible to skip songs and perform other functions.

Tip: If you push ⏻ during ready mode, the display light will turn off within the next 3 seconds.

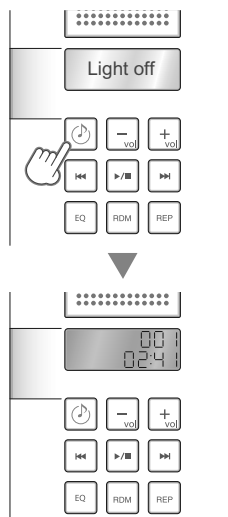

Play Music

Basic Use

Start/stop playing music with Sound Experience

1 If the display is off, push ⏻ to go to ready mode.

2 Push ▶/■ to play music

Tip: If the SD card (Not included) is in place, the music on the card will be played first. (Info about SD card ☞ on page 9)

Displays track number and playing time

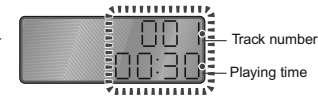

Tip:

- When the display is off, you can push ▶/■ to start playing music.
- If you push ⏻ while playing music, the display will turn off in 3 seconds.

3 Push ▶/■ to stop playing music

Tip:

- If ▶/■ is pushed and then no buttons on the Sound Experience are pushed for the next 2 minutes, the display light will turn off.
- If ▶/■ is not pushed, the Sound Experience will stop playing after 20 minutes. However, continuous play can be set from 1-60 minutes (using 1 minute intervals). For details, please see "Changing the automatic stop timer" section below.
- If the Sound Experience stops playing during a song, it will start from the beginning of that song when play resumes.

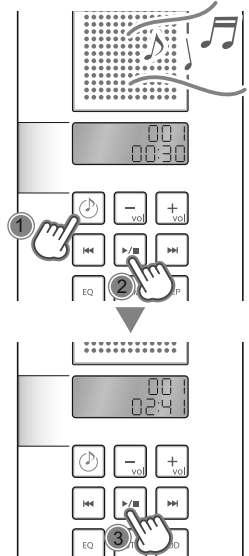

Convenient functions

Changing the automatic stop timer

To change the automatic stop timer, following these instructions.

* If the display light is off, push ⏻ turn it on and put the Sound Experience into ready mode.
* The timer cannot be changed during play. Stop play first.

1 Push ▶/■ for over 10 seconds

The mode changes

Flashing

Push ▶/■ till the display flashes.

2 -vol and +vol are used to set the automatic stop timer.

Ex: To set it to 60 minutes:
Push ▶/■ till 60 appears.

Flashing

Tip:

- The default setting is 20 minutes.
- The automatic stop timer can be set for 1 to 60 minutes (using 1 minute intervals).

3 Push ▶/■ when finished adjusting the timer

Tip:

- If no buttons are pushed for 1 minute while adjusting the automatic stop timer, it will be set to the displayed time.
- If the Sound Experience stops playing and no buttons are pushed for the next 2 minutes, the display light will turn off.



Continuous play

This will play music continuously.

Hold + till -- appears.

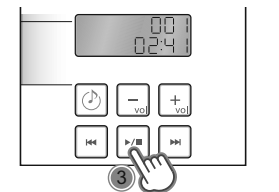

Adjust volume

Basic Use

: Volume up / down

Adjust the volume while music is playing or stopped

※ If the display light is off, push to return to ready mode.

Push to increase volume

The volume is changing

Volume
Playing time

Push to reduce volume

The volume is changing

Volume
Playing time

Quick Push

Tip

- If the button is held down, the volume will continuously change.
- When the music stops playing and no buttons on the Sound Experience are pushed for the next 2 minutes, the display light will turn off.

You can check the volume on the display.

- The display normally shows the song number, push or to show the volume level (1-20).
- After 5 seconds the display will return to showing the song number.

※ When the batteries are almost dead, the volume can only be set to a maximum of "3". Replace the batteries when this happens.

Battery replacement, see [page 4](#)



Jump (Skip Function)

Basic use

: Next / previous song

Skip tracks while the music is stopped.

※ If the display light is off, push to return to ready mode.

To skip to the next song while the music is stopped

Push

Next song

Song number
Playing time

Quick Push

To skip to the previous song while the music is stopped

Push

Previous song

Song number
Playing time

Quick Push

Tip

- If is held down, the Sound Experience will move through the next songs rapidly.
- If is held down, the Sound Experience will move through previous songs rapidly.
- If these buttons are held down, the Sound Experience will jump quickly between songs.

Jump to the Beginning

Basic use

: Jump to the beginning of song

Skip to the beginning of the song while music is playing.

To move to the beginning of next song

Push

The Sound Experience plays the beginning of the next song

song number
Playing time

Short Push

To move to the beginning of previous song

1 Push

The Sound Experience plays the beginning of the current song

Song number
Playing time

2 Push again

The Sound Experience plays the beginning of the previous song

Song number
Playing time

Short Push

Fast forward/rewind

Basic use

: Fast forward/backward

Fast forward or rewind while the music is playing.

Fast forward

Hold

Fast forward

The song is played from the point when where the button is released.

Rewind

Hold

Rewind

The song is played from the point when where the button is released.

Use

Random/Repeated Play

(Random: RDM) (Repeat: REP)

Basic use

: Random/repeated play

Set the play mode while the music is playing or stopped.

Random Repeat

- Random: the Sound Experience plays songs in random order.
- Repeat one: the same song is played in a loop.
- Repeat all: all songs are played in a loop.

※ If the display light is off push to activate ready mode.

To enable random play

1 Push Random mode is engaged



To enable repeated playing

1 Push The "Repeat one" mode is engaged



2 Push again The "Repeat all" mode is engaged



Tip

If the Sound Experience stops playing and no buttons are pushed for the next 2 minutes, the display light will turn off.

Music Quality Setting - Equalizer

Added Feature

: Music quality setting

Select a quality settings while the music is playing or stopped.

※ If the display light is off, push to return to ready mode.

1 Push

2 Push Set the music quality



- "EQ" is shown on the display.
- You can set the quality while the music is playing or stopped.

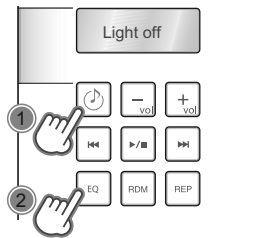

Switch between these quality setting as you push .

Normal	Soft	Mild	Clear	Hard
Natural sound	Low / middle frequencies are rounded, soft sound.	Low / middle frequencies are amplified, gentle sound.	Clean and crisp sound	High / low frequencies are amplified, broad sound
Display	Display	Display	Display	Display
Standard quality	Natural sounds such as babbling	Stringed instruments	Pop music sounds	Rock music sounds

Push for selection

Tip

If the Sound Experience stops playing and no buttons are pushed for the next 2 minutes, the display light will turn off.

Privacy Plus (Water Saver)

Additional Feature

: Privacy Plus makes the sound of flowing water to protect your privacy.

PrivacyPlus If you would like to cover up noises made while using the restroom, push this button. The sound experience will make the sound of flowing water for 25 second.

※ If the display light is off, push to return to ready mode.

1 Push

Tip Push . The Sound Experience make the sound of flowing water after 5 seconds.

2 Push Makes the sound of flowing water for 25 seconds

Tip

- If is pushed again, the Sound Experience will make the same sound for another 25 seconds.
- For volume setting, see page 6.

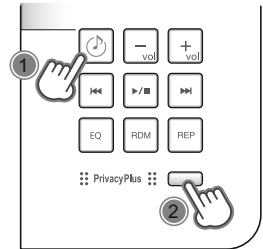

Favorite Songs

Additional Feature

: With an SD card, you can enjoy your favorite music.

About the SD card

About the SD card

- It is a small, light-weight removable external storage media, with which you can save audio, image and video data.
- Not provided with the product, you must buy it elsewhere.

To protect your data

- Enable the "Lock" function to protect your data.

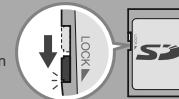

To enjoy your favorite music

- The musical remote control can play files that are in the Mp3 format. You can download them onto the SD card from your personal computer.
- The Sound Experience can access up to 512MB of capacity on the SD card.
- The Sound Experience can use FAT12 and FAT16 formatted SD cards.
- Enjoy your downloaded music but do not infringe on copyrighted or intellectual property rights.
- You can enable the "Lock" function to prevent the data on the SD card from being overwritten.
- Be careful. When data is overwritten, it can not be recovered.

Tip

The volume of the downloaded music of each rhythm may be different due to the recording volume level.

To insert the SD card

- 1 Take out the NEOREST remote control
- 2 Insert the SD card till you feel a "click".

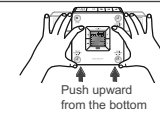

3 Put the NEOREST remote control back in place

To remove the SD card

- 1 Take out the NEOREST remote control
- 2 Gently push the SD card further into the slot
- 3 Then take it out

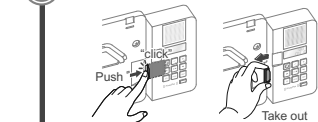

4 Put the NEOREST remote control back in place

Caution

- Do not take out the SD card or the batteries while music is playing, while using privacy plus, or other any sound functions. This may cause damage or malfunction.
- Do not forcefully remove the SD card.
- Do not place the NEOREST remote control on the toilet seat lid.
- This may scratch the lid or cause damage if the remote falls when the lid opens automatically.
- Be careful not to drop the SD card into the NEOREST bowl while it is removed.
- This may clog the toilet and damaged the remote.

Use

Maintenance

Clean the Sound Experience

● Use a soft dry cloth to wipe off dirt or dust on the Sound Experience

- Do not use excessive force when wiping the Sound Experience (This may damage the product.)
- Do not use toilet paper for to clean the Sound Experience. (Sound quality may become poor when lint gets into the speaker.)
- Do not exert excessive force on the display and speaker. (This may cause damage to them.)

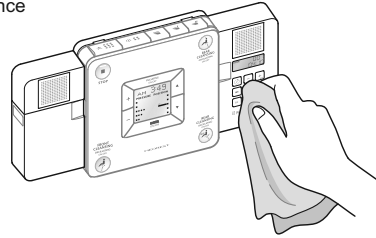

Troubleshooting

When you suspect there is a problem, check the following:



Caution



Do not disassemble

Do not disassemble the Sound Experience for repairs or modification.

- This may damage the Sound Experience.

Before calling for repairs, check the following:

Problem	Inspection	Solution	See
No music, no sound	Are the batteries dead?	▶ Replace the batteries.	4
	Have the batteries been correctly installed? (⊕⊖)	▶ Install them correctly the right way.	4
	Is the volume too low?	▶ Increase the volume.	6
	[If an SD card is used] Is the music file formatted correctly? Is the SD card formatted correct?	▶ Download the music files in correct format. Use a correctly formatted SD card.	9
No sound from speaker	Is the speaker contaminated?	▶ Clean any dirt from the speaker.	
	Is the volume too low?	▶ Increase the volume.	6
Echo	Have you installed the batteries and the remote control correctly?	▶ Install them correctly in the right way.	4
Volume gets weaker	Are the batteries almost dead? (The volume can only be "3" maximum.)	▶ Replace the batteries.	4
Can not skip or use other functions	Is the display light turned off?	▶ Push to return the Sound Experience to ready mode.	6
Can not find a song on experience.	[If an SD card is used] Is the SD card installed correctly?	▶ Install the SD card correctly.	9

Specifications

Item		Content
Rated power	Dry batteries	DC3V (AA X4)
Rated power consumption		220mW (normal, playing)
Memory		SD card (< 512M)
Play mode		MP3 (16 ~ 320kbps) /MP3 VBX
Sound simulation (Privacy Plus)	Sound generation	Sound synthesizer (water flowing sound)
	Sound duration	Approx. 25 seconds per use

Limited Warranty

TOTO U.S.A., INC. THREE YEAR LIMITED WARRANTY

- TOTO warrants its NEOREST 550 ("Product") to be free from defects in materials and workmanship during normal use when properly installed and serviced, for a period of three (3) years from date of purchase. This limited warranty is extended only to the ORIGINAL PURCHASER of the Product and is not transferable to any third party, including but not limited to any subsequent purchaser or owner of the Product. This warranty applies only to TOTO Product purchased and installed in United States, Canada and Mexico.
- TOTO's obligations under this warranty are limited to repair, replacement or other appropriate adjustment, at TOTO's option, of the Product or parts found to be defective in normal use, provided that such Product was properly installed, used and serviced in accordance with instructions. TOTO reserves the right to make such inspections as may be necessary in order to determine the cause of the defect. TOTO will not charge for labor or parts in connection with warranty repairs or replacements. TOTO is not responsible for the cost of removal, return and/or reinstallation of the Product.
- This warranty does not apply to the following items:
 - Damage or loss sustained in a natural calamity such as fire, earthquake, flood, thunder, electrical storm, etc.
 - Damage or loss resulting from any accident, unreasonable use, misuse, abuse, negligence, or improper care, cleaning, or maintenance of the Product.
 - Damage or loss resulting from sediments or foreign matter contained in a water system.
 - Damage or loss resulting from improper installation or from installation of the Product in a harsh and/or hazardous environment, or improper removal, repair or modification of the Product. This includes locations where the water pressure is above local codes or standards. (NOTE: Product model codes allow a maximum of 80 PSI. Check local codes or standards for requirements).
 - Damage or loss resulting from electrical surges or lightning strikes or other acts which are not the fault of TOTO or which the Product is not specified to tolerate.
 - Damage or loss resulting from normal and customary wear and tear, such as gloss reduction, scratching or fading over time due to use, cleaning practices or water or atmospheric conditions.
- If the Danger Label which has been placed over the seams on the back of the Product's top unit is broken or otherwise not intact, this limited warranty is void.
- In order for this limited warranty to be valid, TOTO must receive the completed attached warranty registration card and your proof of purchase within 30 days of the original purchase date.
- If the Product is used commercially or is installed outside of North America, TOTO warrants the Product to be free from defects in materials and workmanship during normal use for one (1) year from the date of installation of the Product, and all other terms of this warranty shall be applicable except the duration of the warranty.
- THIS WARRANTY GIVES YOU SPECIFIC LEGAL RIGHTS. YOU MAY HAVE OTHER RIGHTS WHICH VARY FROM STATE TO STATE OR PROVINCE TO PROVINCE.
- To obtain warranty repair service under this warranty, you must take the Product or deliver it prepaid to a TOTO service facility together with proof of purchase (original sales receipt) and a letter stating the problem, or contact a TOTO distributor or products service contractor, or write directly to TOTO U.S.A., INC., 1155 Southern Road, Morrow, GA 30260 (888) 29578134. If, because of the size of the Product or nature of the defect, the Product cannot be returned to TOTO, receipt by TOTO of written notice of the defect together with proof of purchase (original sales receipt) shall constitute delivery. In such case, TOTO may choose to repair the Product at the purchaser's location or pay to transport the Product to a service facility.

WARNING! TOTO shall not be responsible or liable for any failure of, or damage to, this Product caused by either chloramines in the treatment of public water supply or cleaners containing chlorine (calcium hypochlorite).

NOTE: The use of a high concentrate chlorine or chlorine related products can seriously damage the fittings. This damage can cause leakage and serious property damage.

THIS WRITTEN WARRANTY IS THE ONLY WARRANTY MADE BY TOTO. REPAIR, REPLACEMENT OR OTHER APPROPRIATE ADJUSTMENT AS PROVIDED UNDER THIS WARRANTY SHALL BE THE EXCLUSIVE REMEDY AVAILABLE TO THE ORIGINAL PURCHASER. TOTO SHALL NOT BE RESPONSIBLE FOR LOSS OF THE PRODUCT OR FOR OTHER INCIDENTAL, SPECIAL OR CONSEQUENTIAL DAMAGES OR EXPENSES INCURRED BY THE ORIGINAL PURCHASER, OR FOR LABOR OR OTHER COSTS DUE TO INSTALLATION OR REMOVAL, OR COSTS OF REPAIRS BY OTHERS, OR FOR ANY OTHER EXPENSE NOT SPECIFICALLY STATED ABOVE. IN NO EVENT WILL TOTO'S RESPONSIBILITY EXCEED THE PURCHASE PRICE OF THE PRODUCT. EXCEPT TO THE EXTENT PROHIBITED BY APPLICABLE LAW, ANY IMPLIED WARRANTIES, INCLUDING THAT OF MERCHANTABILITY OR FITNESS FOR USE OR FOR A PARTICULAR PURPOSE, ARE EXPRESSLY DISCLAIMED. SOME STATES DO NOT ALLOW LIMITATIONS ON HOW LONG AN IMPLIED WARRANTY LASTS, OR THE EXCLUSION OR LIMITATION OF INCIDENTAL OR CONSEQUENTIAL DAMAGES, SO THE ABOVE LIMITATION AND EXCLUSION MAY NOT APPLY TO YOU.