

Curva™ Self-Rimming Lavatory

FEATURES

- 22" x 19"
- Front overflow
- Vitreous china
- Complete with installation template
- ADA compliant

MODELS

- LT180
Lavatory without faucet hole



COLORS/FINISHES

- #01 Cotton
- #03 Bone
- #11 Colonial White
- #12 Sedona Beige

CODES/STANDARDS

- Meets and exceeds ASME A112.19.2/CSA B45.1
- Certifications: IAPMO(cUPC), State of Massachusetts, City of Los Angeles, and others
- ADA compliant
- Code compliance: UPC, IPC, NSPC, NPC Canada, and others



PRODUCT SPECIFICATION

The self-rimming lavatory shall be made of vitreous china. Lavatory shall be 22" in length and 19" in width. Product shall be with overflow and lavatory shall include mounting assembly and be ADA compliant. Lavatory shall be TOTO Model LT180_____.

LT180

Curva™ Self-Rimming Lavatory

SPECIFICATIONS

- Waste 1-1/4" O.D.
- Size 22"W x 19"D
- Basin 16"W x 13"D
- Warranty One Year Limited Warranty
- Material Vitreous china
- Shipping Weight 28 lbs.
- Shipping Dimensions 23"W x 20"D x 8-1/2"H

INSTALLATION NOTES

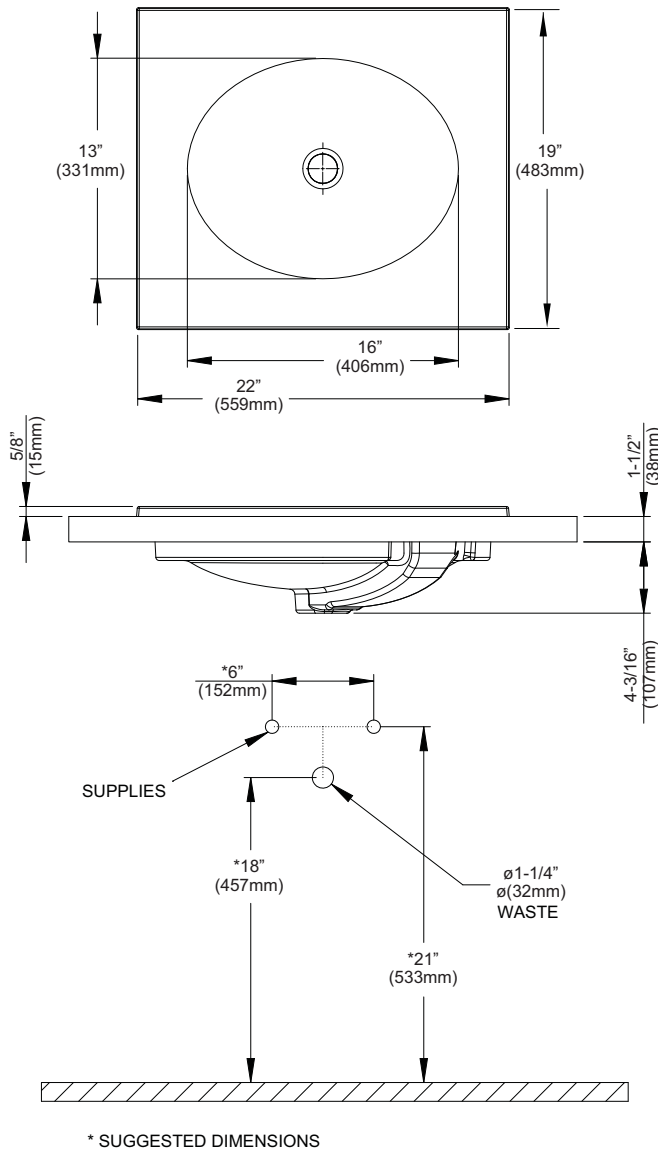

ADA Compliance Check

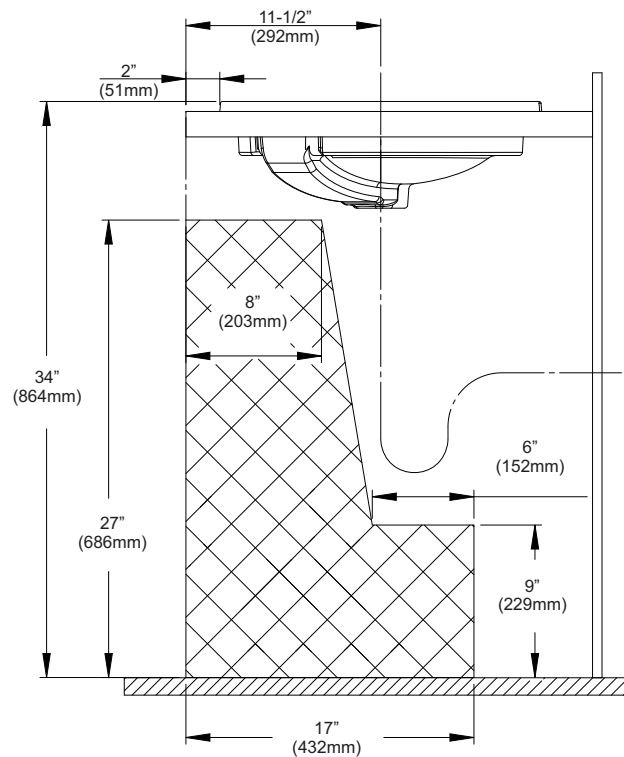

TOTO®

These dimensions and specifications are subject to change without notice

Ph: (888) 295-8134 | Fax: (800) 699-4889 | www.totousa.com

#SS-00428 v.02

Printed in U.S.A. | © TOTO LTD. 02/10 | Printed on recycled paper ♻️